

Installation Precautions:

1. Please read through the Instructions before installation.
2. This luminaire is used in the W2 three-phase track system or on compatible tracks from other company brands, with rail parameters: Input voltage: AC 220-240V; Maximum current: 16A; Maximum load: 3680W;
3. Installed by a qualified electrician;
4. To avoid the risk of electric shock, please confirm that the power is turned off before installing and maintaining the luminaire;
5. Only suitable for indoor installation (not suitable for humid environments);
6. The light source of this luminaire is non-replaceable. If replacement is necessary (such as when the light source reaches the end of its life), the entire luminaire should be replaced;
7. Please keep this manual properly for future use.

Warning: Do not touch the reflector's light outlet with your fingers or other objects, otherwise it will affect the light output effect!



Assemble The Guide Rail Lamp Connector:

1. Before assembly, ensure that the "conductive switch" is parallel to the connector, and press the "1", "2", or "3" gear state displayed within the ring of the phase-change knob as required

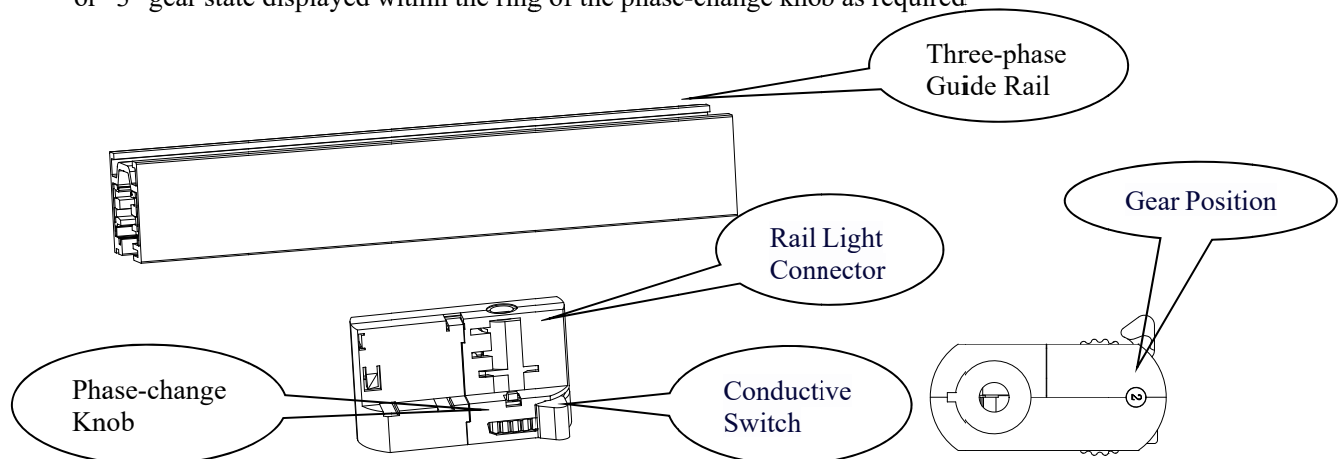

- Align the projection of the guide rail light connector with the groove of the guide rail before assembly.

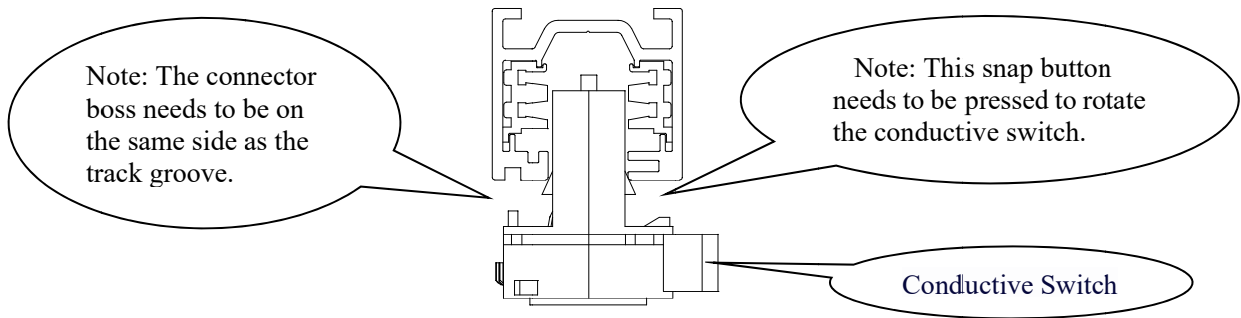

- After assembly, turn the "Conductive Switch" clockwise by 90 degrees to conduct.

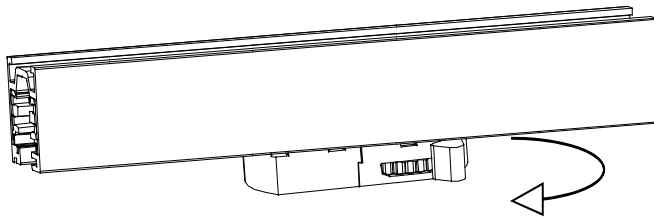

Note: The procedure for removing the guide rail light connector is the reverse of the procedure for installing the guide rail light connector.

Brightness Adjustment (Please refer to the Bluetooth manual for Bluetooth dimming):

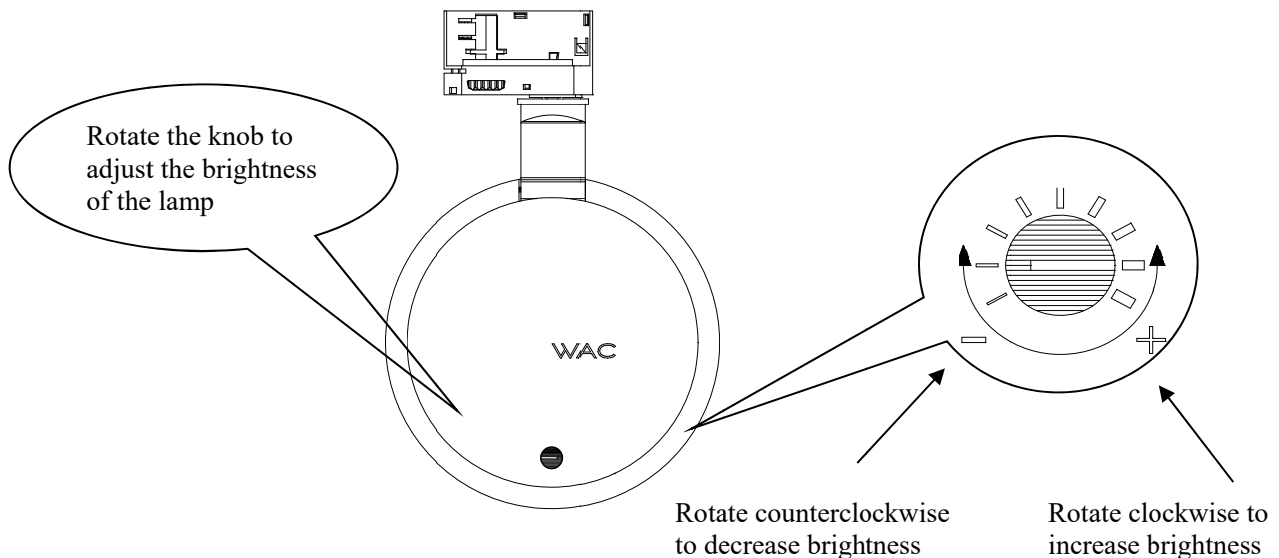

Lighting Adjustment:

- After the lamp is installed, the lamp body can be rotated vertically by 90° and horizontally by 355°.

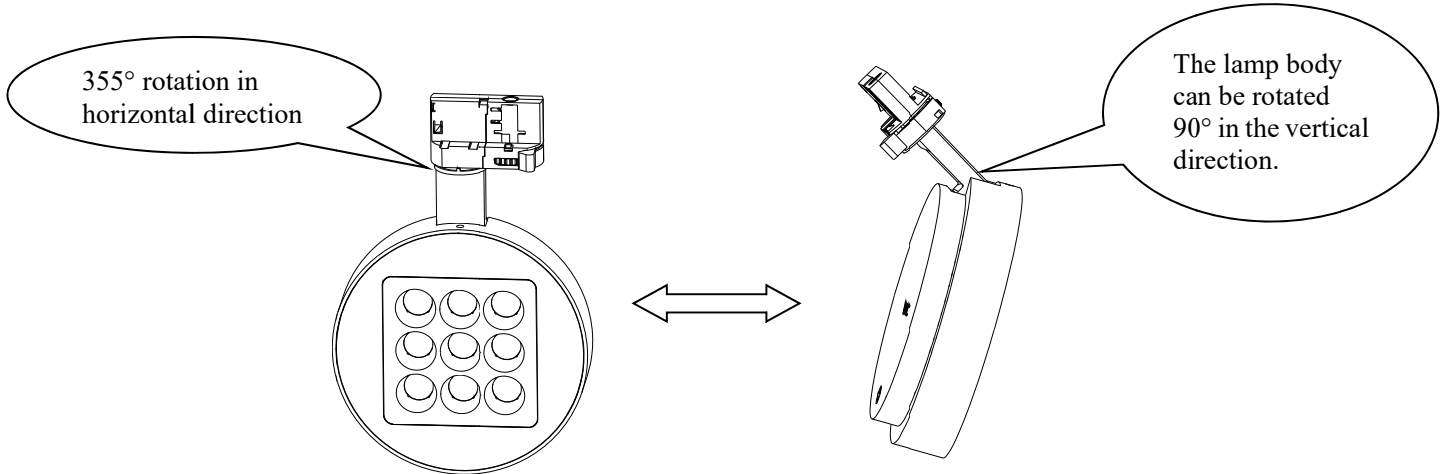

Installation of Accessories:

1. Turn the lamp body down to the appropriate position, align the small slotted screwdriver with the gap in the front cover, pry off the front cover, and then pull it out with your hand.
2. Remove the glass or diffusion film and replace it with the selected optical accessory or optical film.

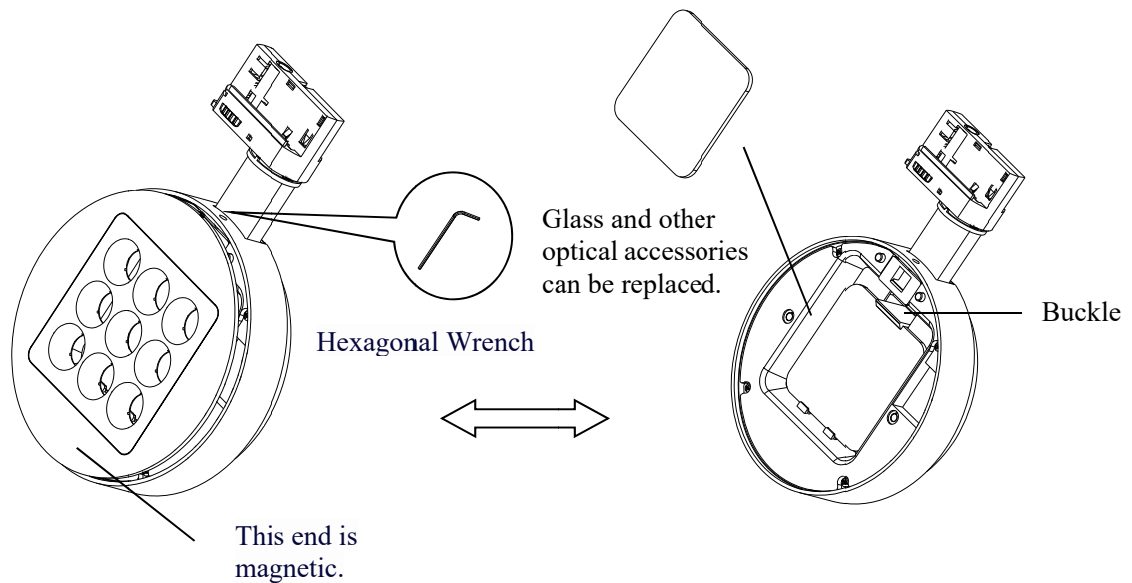

3. The installation sequence is the reverse of the removal sequence. Install the cover in the direction of the corresponding buckle, and it is considered to be installed when you hear a "click" sound and the cover of the lamp has no protrusions.

Maximum Lifting Weight:

1. The maximum weight that the track system can withstand is shown in the following figure, which includes the weight of the entire suspension system.
2. The maximum load that a single adapter can bear is 10kg (the load is applied to the adapter according to the normal installation position of the lamp).

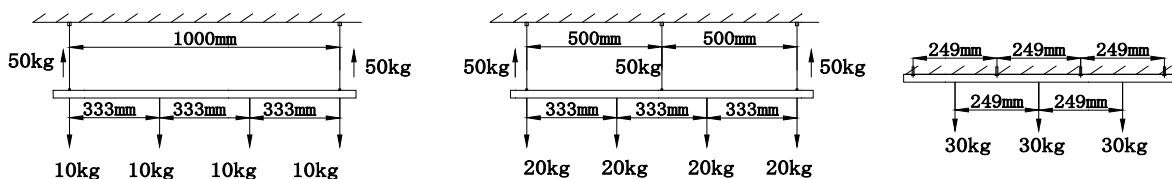

Licensed by "WAC" trademark holder - WAC LIGHTING, USA
 Chinese Marketing Headquarters : WAC Lighting (Shanghai) Co, Ltd.
 Address : 14, Lane 299, Bi Sheng Road, Shanghai 201204, China
 China factory : Manufactured WAC Lighting (Dongguan) Co, Ltd.
 Address : 390, Qingfeng Road, Qingxi Town, Dngguan, Guangdong. Postal code: 523653